

MORGAN RIDGE

100 Morgan Ridge Way
Winston Salem, NC 27127 | 1-855-782-9847



Welcome Home to exceptional living in the heart of Winston-Salem, NC. Located near the corner of Morgan Way and Southpark Blvd, just off of Peters Creek Pkwy, Morgan Ridge offers a desirable location just minutes from endless dining and entertainment. Morgan Ridge offers 10 unique floor plans, ranging from one, two and three-bedroom apartment homes and exclusive amenities such as an onsite Clothing Care Center, 24-Hour Health and Wellness Center, Onsite Car Care Center and Doorstep Trash Valet Services. Come relax next to one of our two Resort-Style Swimming Pools or enjoy an afternoon picnic at our outdoor Grilling Area. We're sure Morgan Ridge will meet every family member's needs. A comfortable and enjoyable lifestyle is our goal at Morgan Ridge. Take a moment to browse our expansive list of interior Apartment Amenities and photo gallery to see why Morgan Ridge is the perfect home for you!



FLOORPLANS

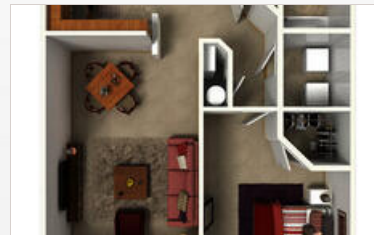

COMMUNITY/APARTMENT AMENITIES

- Air Conditioning
- Business Center
- Dishwasher
- Fitness Center
- High-speed Internet access
- Large closets/storage
- Outdoor Pool
- Patio or Balcony
- Pet Friendly
- Playground
- Washer/Dryer in-suite

LEARN MORE ON OUR WEBSITE

<https://www.vipcorporatehousing.com/properties/morgan-ridge.html>