

## LEGACY AT FRIENDLY MANOR

5402 Friendly Manor Drive  
Greensboro, NC 27410 | 1-888-249-5719



Legacy at Friendly Manor is a fitting name for an apartment community where historical reverence blends in perfect harmony with contemporary living. While Friendly is the name of the main road through the Guilford College area of Greensboro, NC, it also describes the attitude of the staff and residents. There is a strong sense of community here, where traditional buildings of historical significance stand alongside newly-built examples of modern architecture. Offering a diverse selection of 1-, 2-, and 3- bedroom floor plans, both building styles are equipped with modern conveniences. Neighbors love to meet at the clubhouse for coffee in the Internet Café, surf the web with our free Wi-Fi by the pool, or enjoy their favorite DVDs from the library selection in the 24-Seat, 106" screen multi-media theatre. The 24-hour business center and the expansive, fully-equipped fitness center are open 24/7. At Legacy at Friendly Manor, modern-day convenience encounters old-fashioned southern charm.



### FLOORPLANS

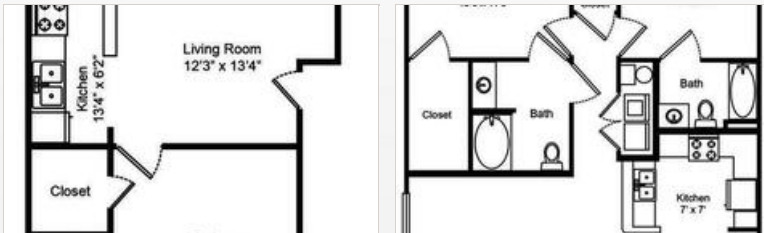

### COMMUNITY/APARTMENT AMENITIES

- Air Conditioning
- Business Center
- Dishwasher
- Fitness Center
- High-speed Internet access
- Large closets/storage
- Outdoor Pool
- Pet Friendly
- Washer/Dryer in-suite

### LEARN MORE ON OUR WEBSITE

<https://www.vipcorporatehousing.com/properties/legacy-at-friendly-manor.html>