

## WOODMILL APARTMENTS

1300 South Farmview Drive  
Dover, DE 19904 | 1-888-249-5719



COME LIVE THE GOOD LIFE! At Woodmill Apartments we've designed a home just for you in mind. Our exceptionally large floorplans give you all the room needed to relax at a price that is more than affordable. We are conveniently located to shopping, dining and entertainment, not to mention Route 13 and Route 1. Public transportation is within walking distance from your door. The staff at Woodmill will be sure you are getting all you deserve in an apartment home.



### FLOORPLANS

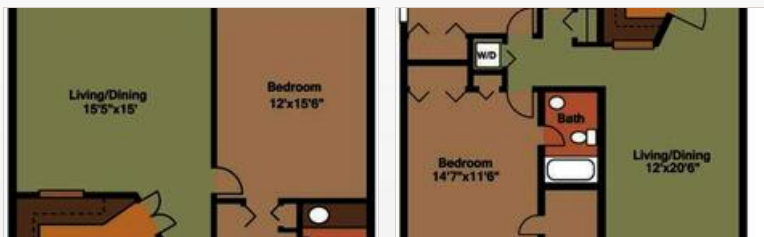

### COMMUNITY/APARTMENT AMENITIES

- Air Conditioning
- Business Center
- Covered Parking
- Dishwasher
- Fitness Center
- Garage Parking
- High-speed Internet access
- Large closets/storage
- Outdoor Pool
- Patio or Balcony
- Pet Friendly
- Playground
- Washer/Dryer in-suite

### LEARN MORE ON OUR WEBSITE

<https://www.vipcorporatehousing.com/properties/woodmill-apartments.html>